

McCARTY (R.O.)  
1247/138

VAUGHN & HANLEY (R.O.)  
1812/331

PERRY (R.O.)  
14833/101

LOT 32

LOT 33

LOT 41

LOT 40

R=2325.00'  
L=288.56'  
CH=N 16°40'41" W  
288.38'

**TITLE INFORMATION**

JOHN DOE  
P/O DEED BOOK 1980 PAGE 113  
P/O TAX MAP NO. 372-1-20.21  
AREA= 38.588 ACRES TO C/L  
(37.785 ACRES TO R/W)  
(VACANT AGRICULTURAL FIELD)

**NOTES**

- 1- Unauthorized alteration or addition to a survey map bearing a licensed land surveyor's seal is a violation of section 7209, sub-division 2, of the New York State Education Law.
- 2- Only copies from the original of this survey map with the surveyor's embossed seal are genuine, true and valid copies of the surveyor's original work and opinion.
- 3- Certifications on this boundary survey map signify that the map was prepared in accordance with the current existing Code of Practice for Land Surveys adopted by the New York State Association of Land Surveyors, Inc. The certification is limited to persons for whom the boundary survey map is prepared, to the title company, and to the lending institution listed on this survey map and are not transferable.

**LEGEND**

- - COMPUTED POINT
- - IRON PIN/PIPE FOUND
- ⊙ - 3/4" REBAR SET WITH CAP
- ⊕ - UTILITY POLE
- ⊞ - TELEPHONE PEDESTAL
- - FENCE & HEDGE
- - CONCRETE HIGHWAY MONUMENT FOUND
- ⊗ - GAS PIPELINE MARKER

"DEED TO CENTERLINE OF ROAD, EXCEPT & RESERVE ALL EXISTING PUBLIC ROAD & UTILITY RIGHT OF WAYS"

I hereby certify to: \_\_\_\_\_  
that I am a licensed land surveyor, New York State License No. 050823, and that this map delineates an actual survey on the ground made by me or under my direct supervision, that it was prepared in accordance with the current Code of Practice adopted by the New York State Association of Professional Land Surveyors, and that I found no visible encroachments either way across property lines except as shown hereon.

SIGNED: EDWARD RIPIC, JR. DATE: 3/3/2017

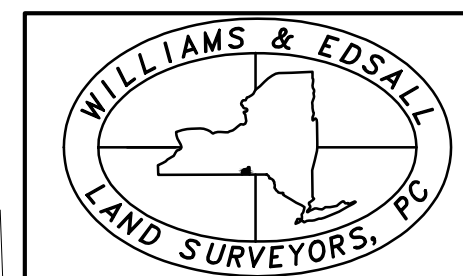

WILLIAMS AND EDSALL LAND SURVEYORS, P.C.  
The Turner House Suite 101  
24 NYS Rte 96 Owego, NY 13827  
phone/fax: (607)687-8953  
www.williamsandedsall.com

Survey map showing lands of  
**JOHN DOE**  
LOCATED ON GRIDLEY ROAD  
WHISKEY CREEK ROAD & RED SCHOOL ROAD  
TOWN of CATON

STEBEN COUNTY NEW YORK  
DATE: 3/3/2017 SCALE: 1"=120'  
JOB NO: 2017-051  
© COPYRIGHT 2017

